

**Legend**

- Alternative 10a
- Limit of Grading
- Archaeological Resource Impacts**
  - Probable Sensitivity
  - Sensitive
  - Verified Site
- Archaeological Resource**
  - Probable Sensitivity
  - Sensitivity
  - Verified Sites & Cem
  - Verified Sites-Not Eligible

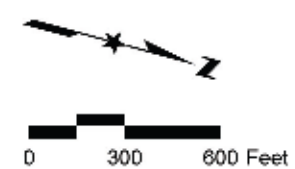

*Vanasse Hangen Brustlin, Inc.*

**Figure 4.17-1**  
**Potential Archaeological Impacts,**  
**Newington Alternative 10A**

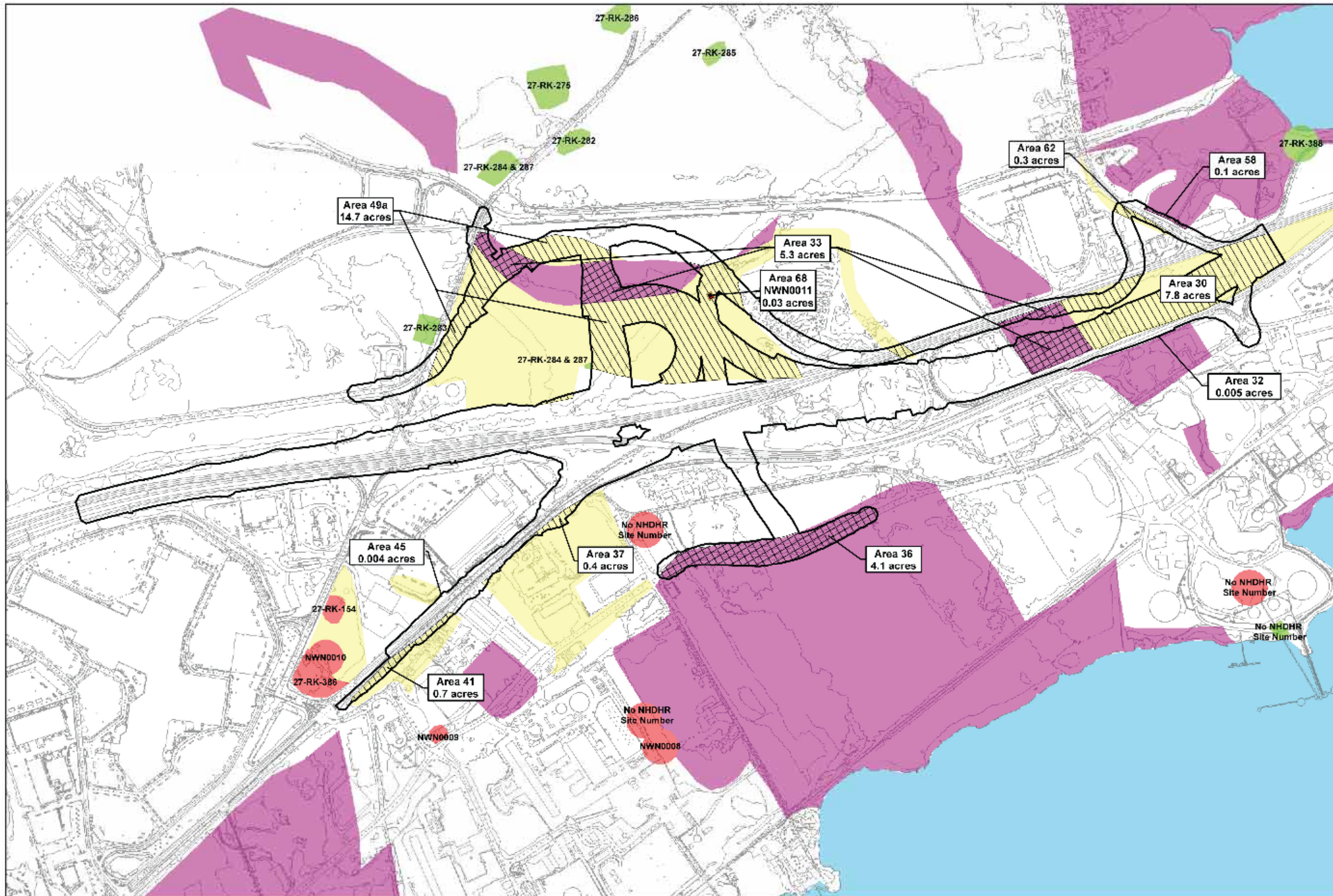

**Legend**

- Alternative 12a
- Limit of Grading
- Archaeological Resource Impacts**
- Probable Sensitivity
- Sensitive
- Verified Site
- Archaeological Resource**
- Probable Sensitivity
- Sensitivity
- Verified Sites & Cem
- Verified Sites-Not Eligible

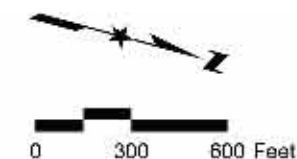

*Vanasse Hangen Brustlin, Inc.*

**Figure 4.17-2**  
**Potential Archaeological Impacts,**  
**Newington Alternative 12A**

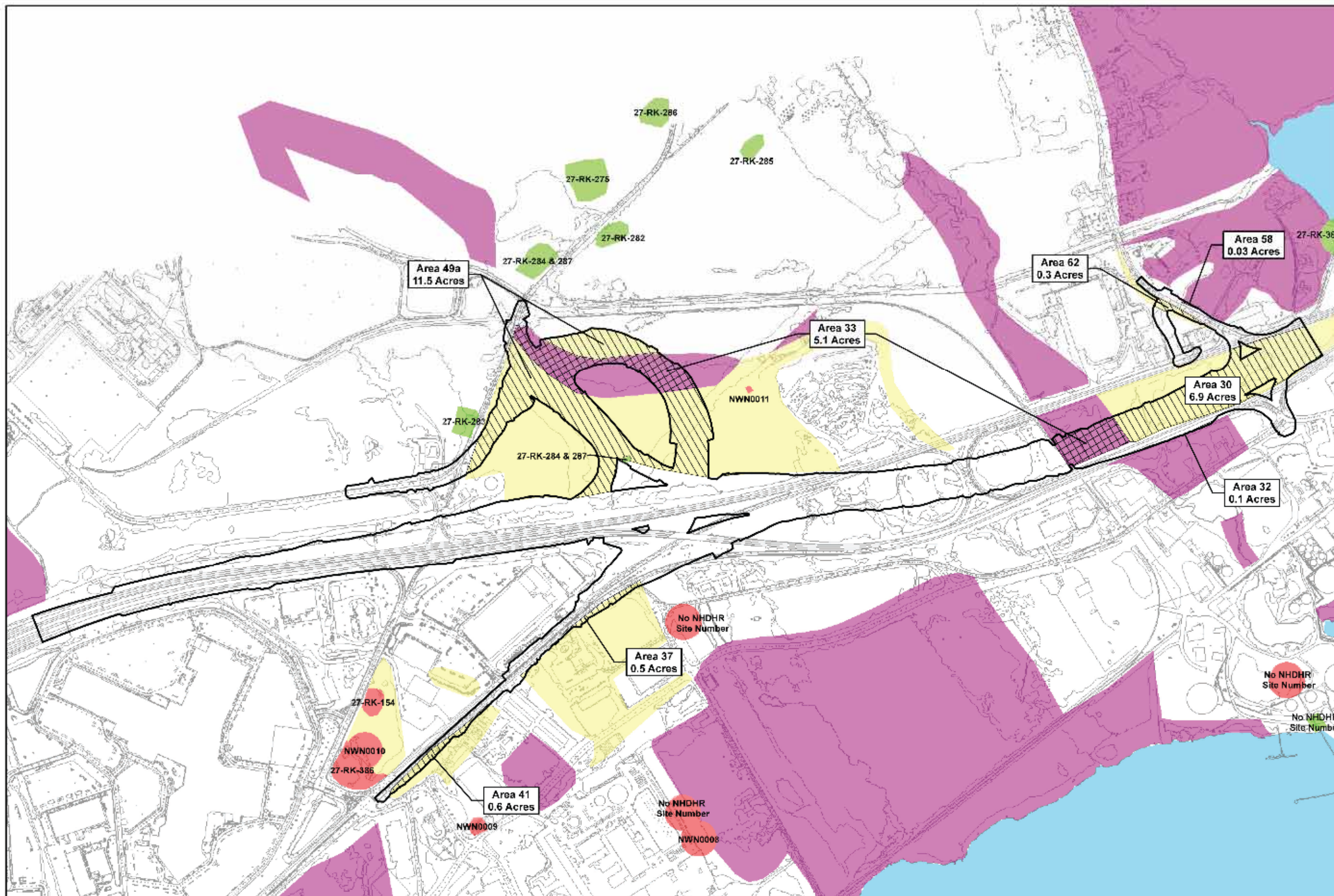

**Legend**

- Alternative 13 Limit of Grading
- Archeological Resource Impacts**
  - ▨ Probable Sensitivity
  - ▩ Sensitivity
  - Verified Site
- Archeological Resource**
  - Probable Sensitivity
  - Sensitivity
  - Verified Sites & Cem
  - Verified Sites-Not Eligible

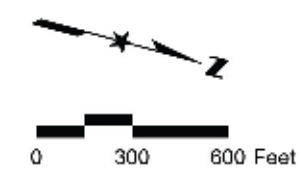

*Vanasse Hangen Brustlin, Inc.*

**Figure 4.17-3**  
**Potential Archaeological Impacts,**  
**Newington Alternative 13**

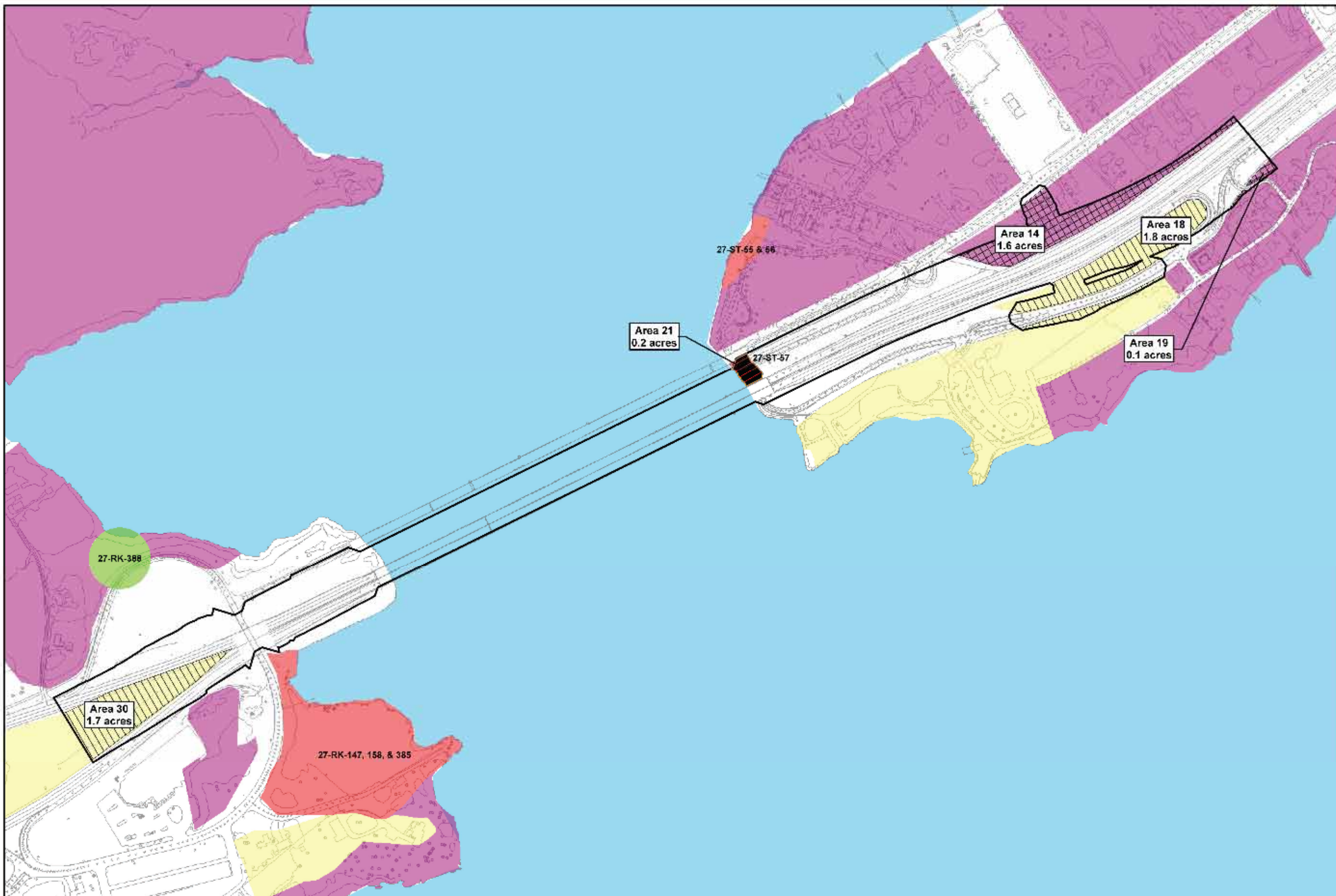

**Legend**

- Bridge - Widen & Remove
- Limit of Grading
- Archeological Resource Impacts**
- Probable Sensitivity
- Sensitive
- Verified Site
- Archeological Resource**
- Probable Sensitivity
- Sensitivity
- Verified Sites & Cem
- Verified Sites-Not Eligible

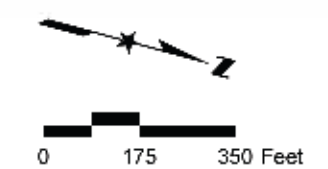

*Vanasse Hangen Brustlin, Inc.*

**Figure 4.17-4**  
**Potential Archaeological Impacts,**  
**Widen West / Remove Alternative**

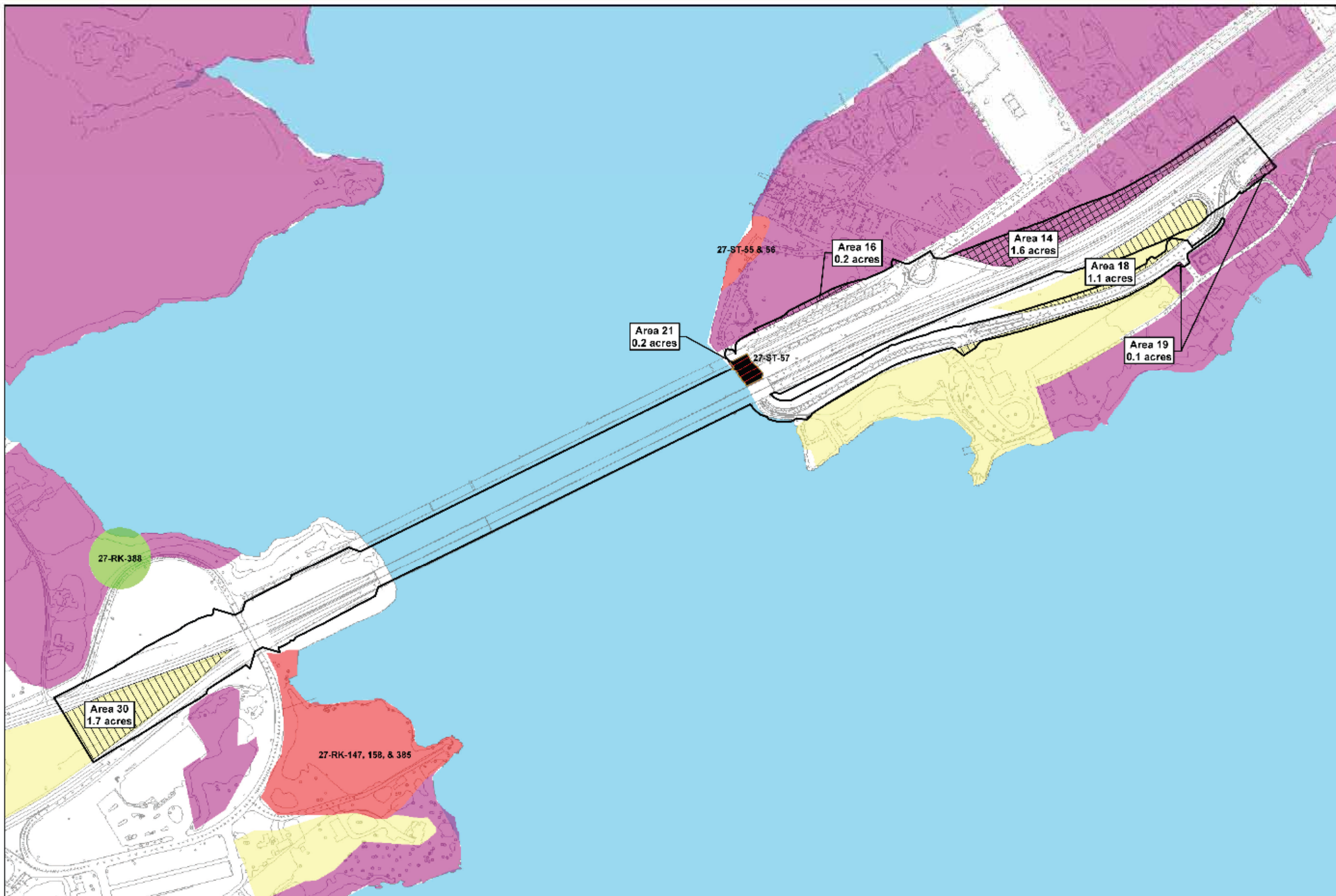

**Legend**

- Widen & Remove
- Limit of Grading
- Archeological Resource Impacts**
- Probable Sensitivity
- Sensitive
- Verified Site
- Archeological Resource**
- Probable Sensitivity
- Sensitivity
- Verified Sites & Cem
- Verified Sites-Not Eligible

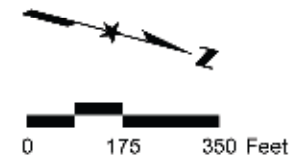

*Vanasse Hangen Brustlin, Inc.*

**Figure 4.17-5**  
Potential Archaeological Impacts,  
Widen West / Rehabilitate Alternative



**Legend**

- Alternative 2
- Limit of Grading
- Archeological Resource Impacts**
  - Probable Sensitivity
  - Sensitive
  - Verified Site
- Archeological Resource**
  - Probable Sensitivity
  - Sensitivity
  - Verified Sites & Cem
  - Verified Sites-Not Eligible

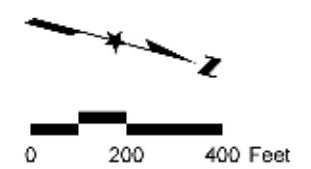

*Vanasse Hangen Brustlin, Inc.*

**Figure 4.17-6**  
**Potential Archaeological Impacts,**  
**Dover Alternative 2**



**Legend**

- Alternative 3
- Limit of Grading
- Archeological Resource Impacts**
- Probable Sensitivity
- Sensitive
- Verified Site
- Archeological Resource**
- Probable Sensitivity
- Sensitivity
- Verified Sites & Cem
- Verified Sites-Not Eligible

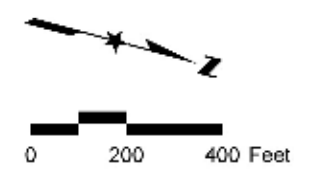

*Vanasse Hangen Brustlin, Inc.*

**Figure 4.17-7**  
**Potential Archaeological Impacts,**  
**Dover Alternative 3**

**NEWINGTON ALTERNATIVE 10A**

ROW: 25,600 sq. ft.  
SLOPE: 275 sq. ft.  
TOTAL: 25,875 sq. ft.

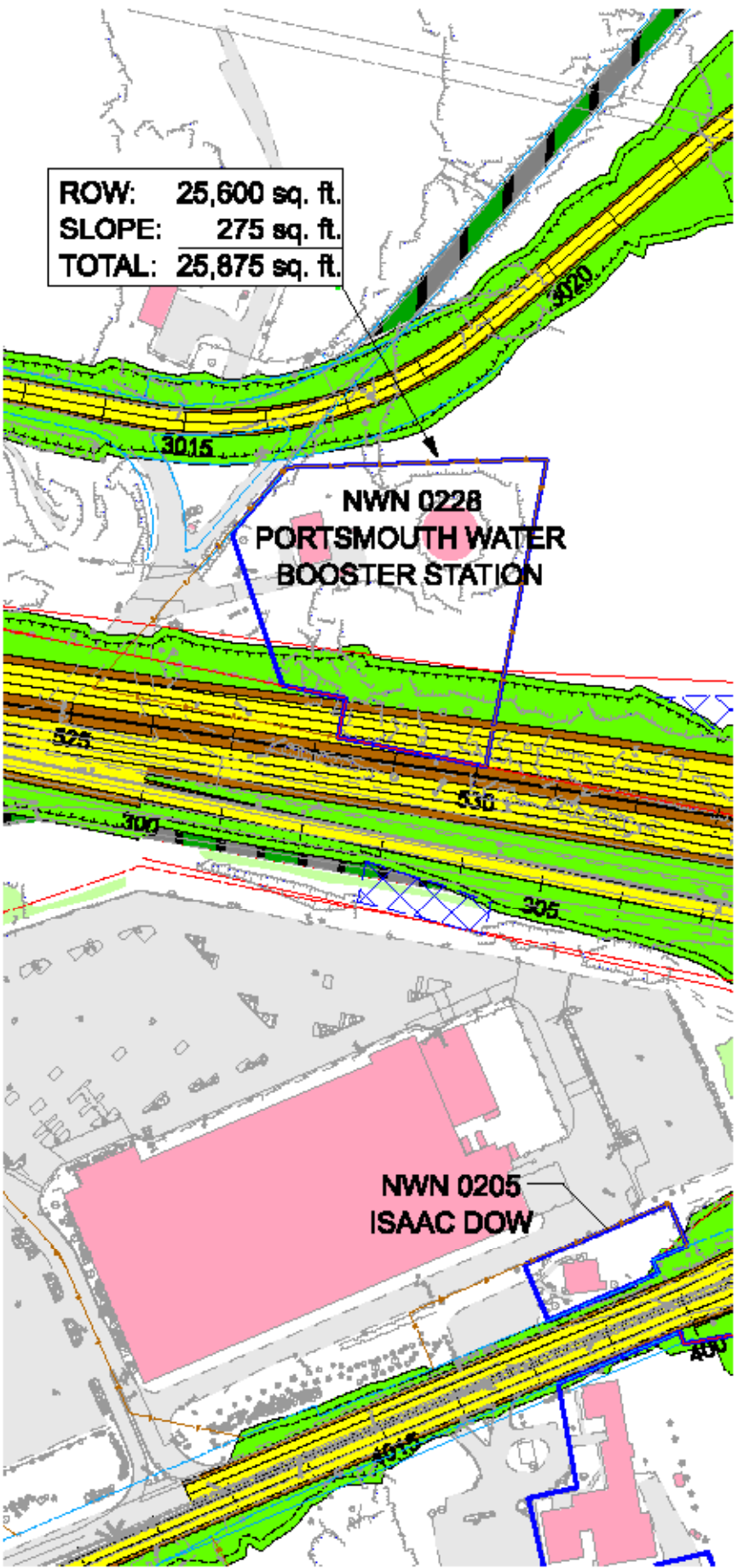

**NEWINGTON ALTERNATIVE 12A**

ROW: 31,175 sq. ft.  
SLOPE: 0 sq. ft.  
TOTAL: 31,175 sq. ft.

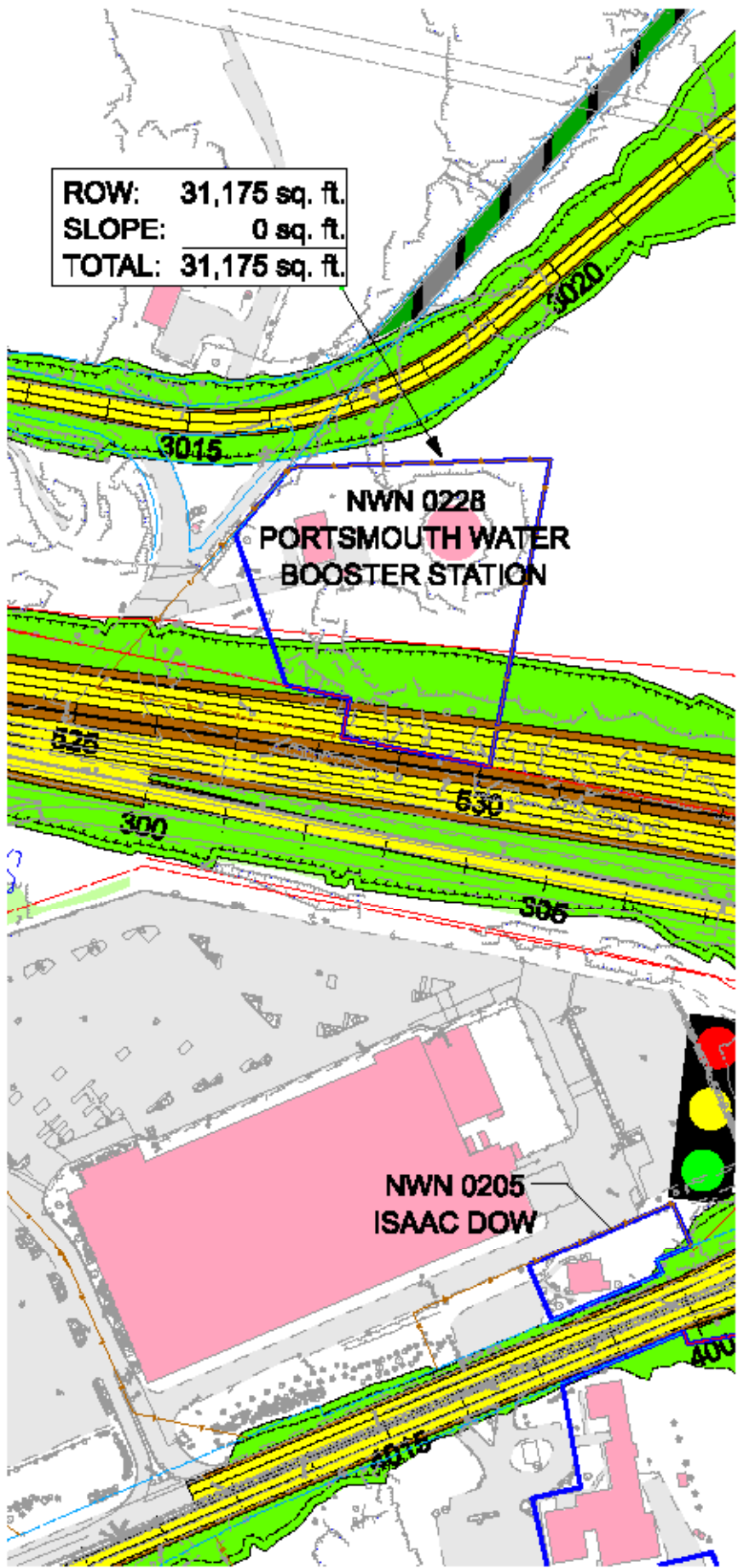

**NEWINGTON ALTERNATIVE 13**

ROW: 33,125 sq. ft.  
SLOPE: 400 sq. ft.  
TOTAL: 33,525 sq. ft.

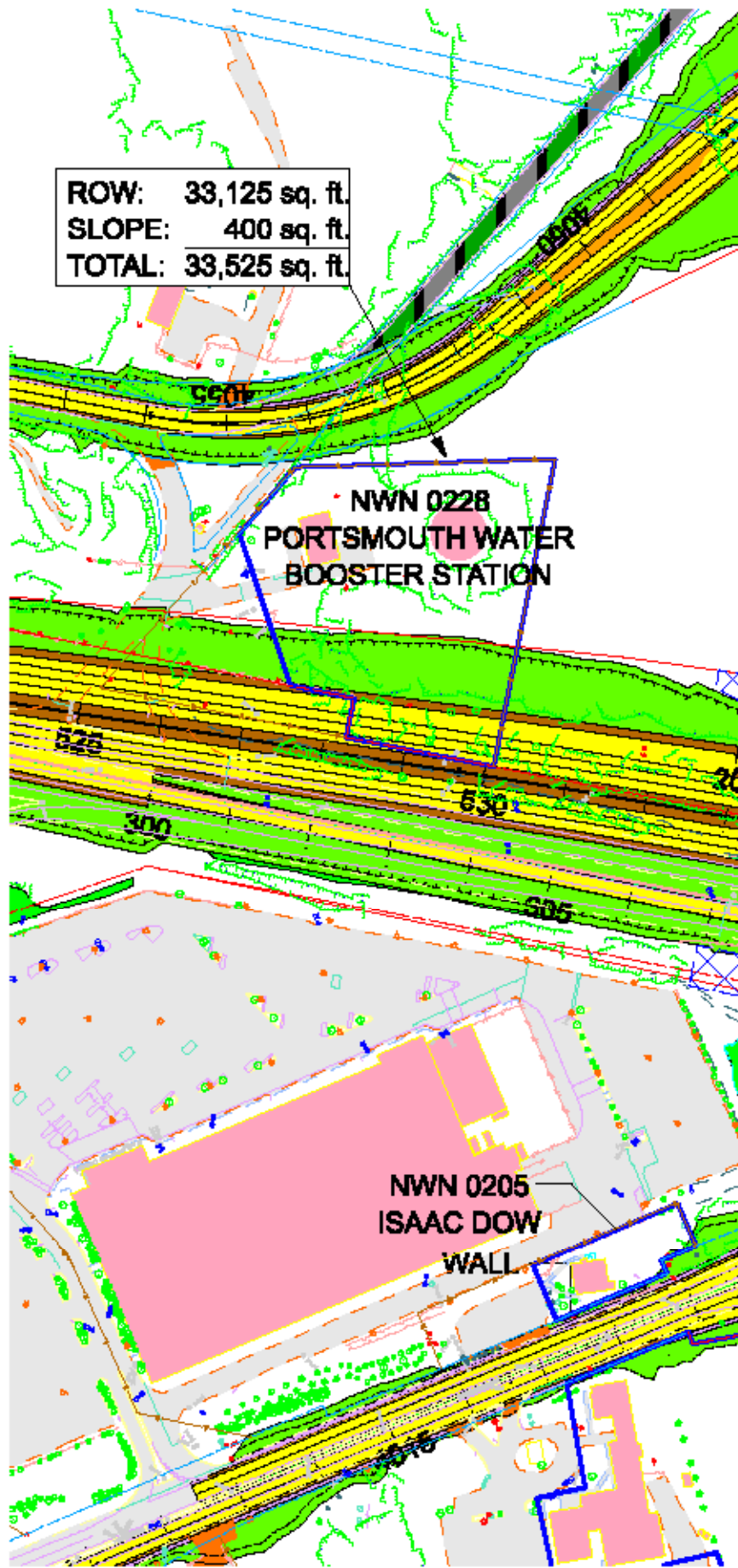

**Legend:**

- Existing Roadway
- Existing Building
- Existing Wetland
- Existing Property Lines
- Proposed Roadway
- Proposed Bridge
- Proposed Rail Corridor
- Proposed Acquisition
- Pavement Removal
- Existing LAROW
- Existing CAROW
- Existing ROW
- Proposed LAROW
- Proposed CAROW
- Proposed ROW
- Historic Structure (Listed or Eligible for Listing)

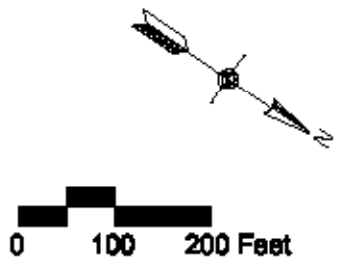

*Vansse Hangen Brustlin, Inc.*

Figure 5.4-1  
Section 4(f) Impacts  
NWN 0228  
Newington



NEWINGTON ALTERNATIVE 12A

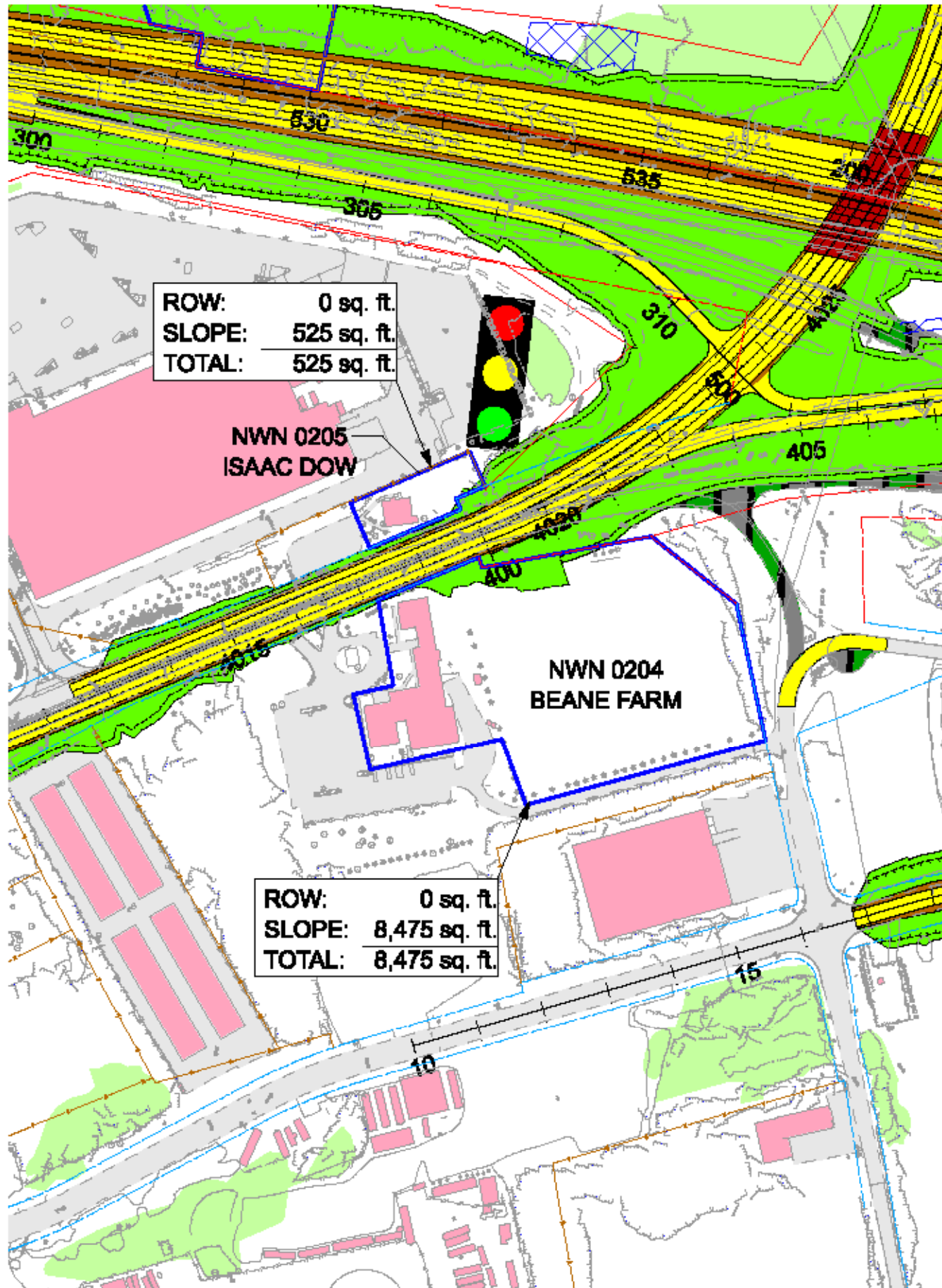

NEWINGTON ALTERNATIVE 13

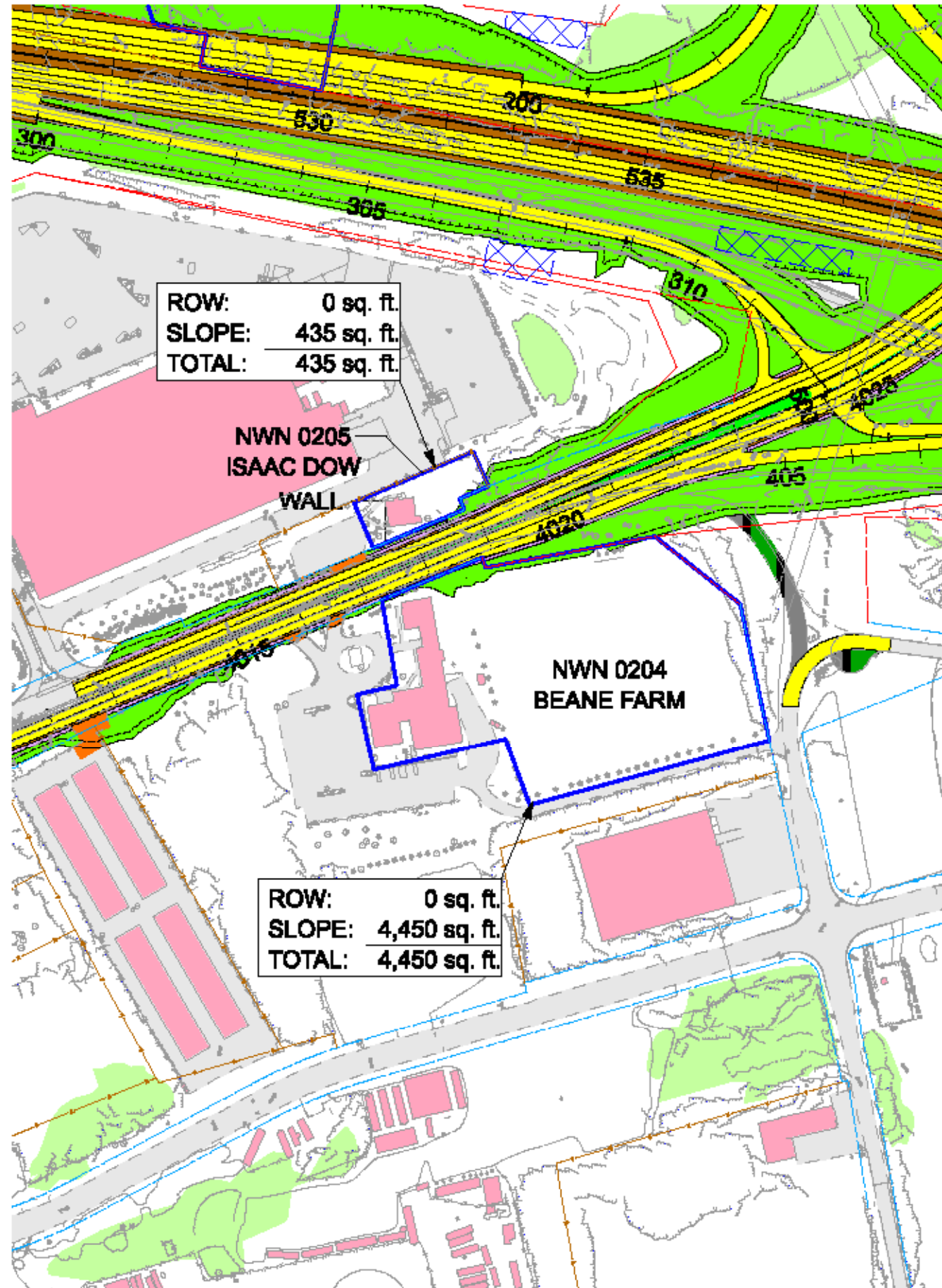

- Legend:**
- Existing Roadway
  - Existing Building
  - Existing Wetland
  - Existing Property Lines
  - Proposed Roadway
  - Proposed Bridge
  - Proposed Rail Corridor
  - Proposed Acquisition
  - Pavement Removal
  - Existing LAROW
  - Existing CAROW
  - Existing ROW
  - Proposed LAROW
  - Proposed CAROW
  - Proposed ROW
  - Historic Structure (Listed or Eligible for Listing)

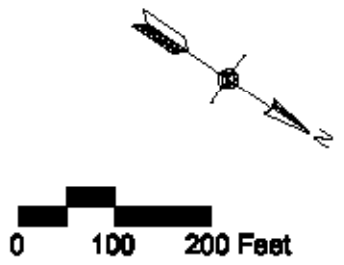

*Vansse Hangen Braslin, Inc.*

Figure 5.4-2  
 Section 4(f) Impacts  
 NWN 0204, NWN 0205  
 Newington

\* Newington Alternative 10A and 12A have Similar Configurations.

**Widen West and Rehabilitate General Sullivan Bridge**

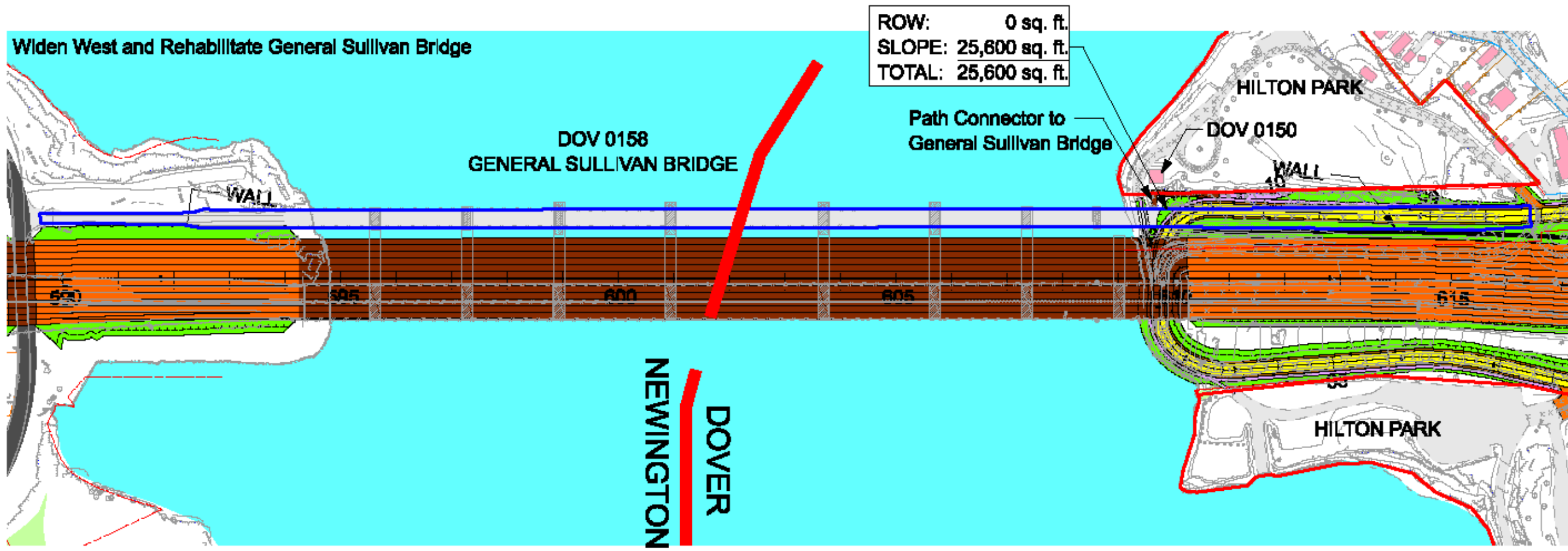

- Legend:**
- Existing Roadway
  - Existing Building
  - Existing Wetland
  - Existing Property Lines
  - Proposed Roadway
  - Proposed Bridge
  - Proposed Rail Corridor
  - Proposed Sidewalk
  - Proposed Acquisition
  - Existing LAROW
  - Existing CAROW
  - Existing ROW
  - Proposed LAROW
  - Proposed CAROW
  - Proposed ROW
  - Historic Structure (Listed or Eligible for Listing)
  - Park Boundary

**Widen West and Remove General Sullivan Bridge**

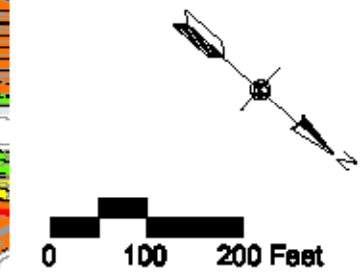
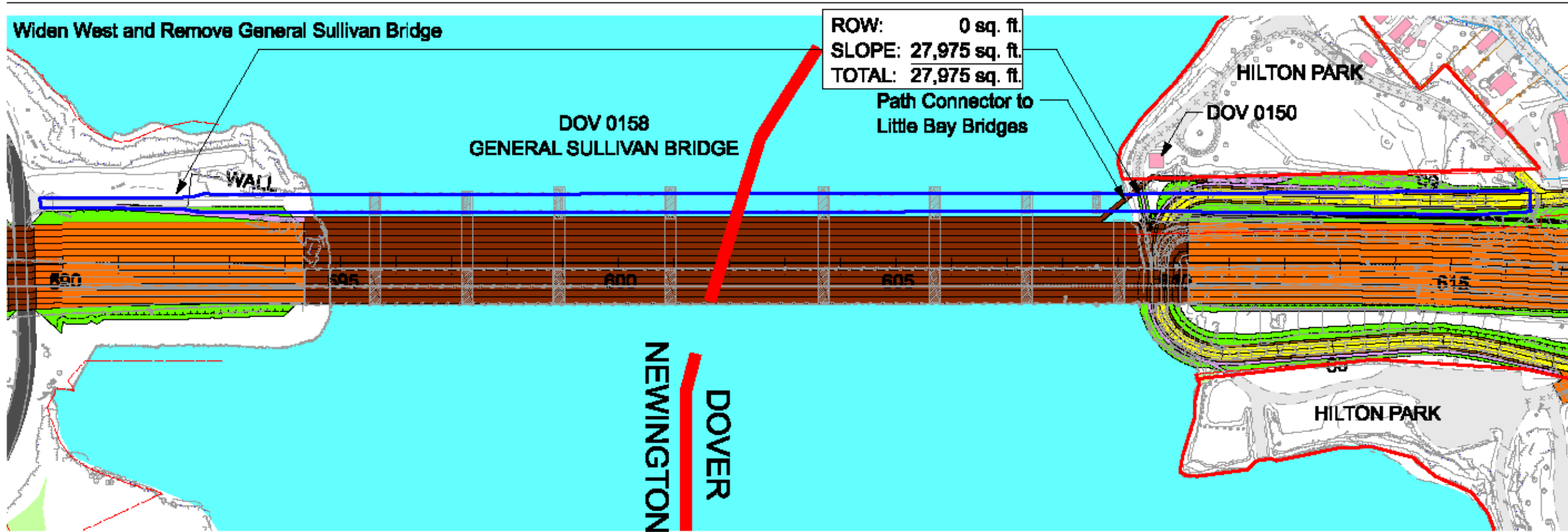

*Vansse Hangen Brustlin, Inc.*

Figure 5.4-3  
Section 4(f) Impacts  
DOV 0158  
General Sullivan Bridge, Dover

\* Newington Alternatives 10A, 12A and 13 have Similar Configurations.  
Dover Alternatives 2 and 3 have Similar Configurations.

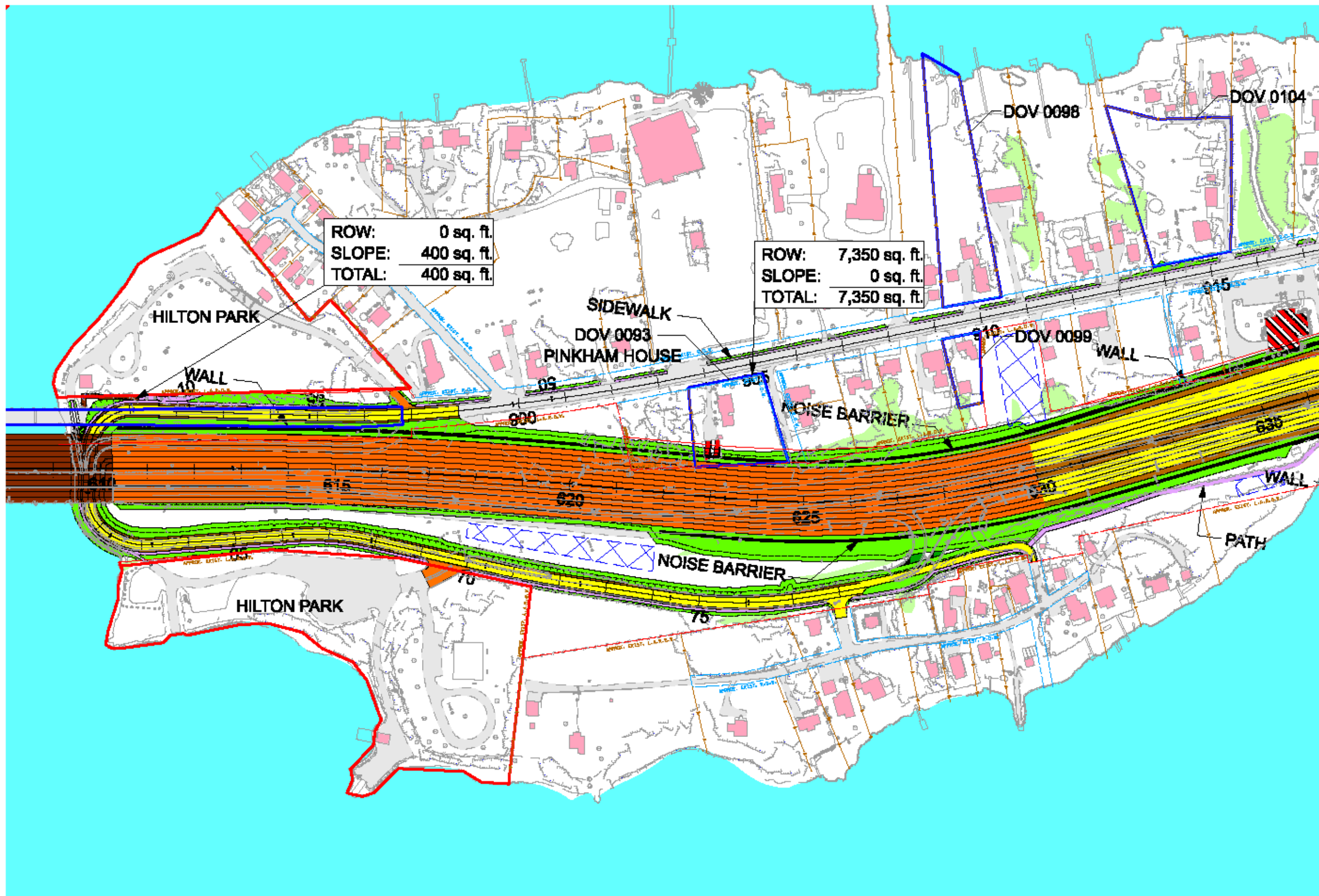

- Legend:**
- Existing Roadway
  - Existing Building
  - Existing Wetland
  - Existing Property Lines
  - Proposed Roadway
  - Proposed Bridge
  - Proposed Rail Corridor
  - Proposed Acquisition
  - Pavement Removal
  - Existing LAROW
  - Existing CAROW
  - Existing ROW
  - Proposed LAROW
  - Proposed CAROW
  - Proposed ROW
  - Historic Structure (Listed or Eligible for Listing)
  - Park Boundary

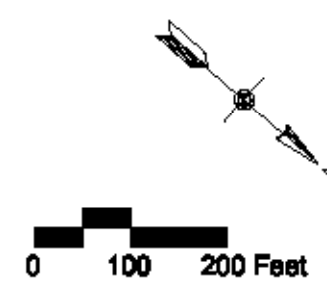

*Vansse Hangen Brustlin, Inc.*

Figure 5.4-4  
Section 4(f) Impacts  
Hilton Park, DOV 0093  
Dover

\* Dover Alternatives 2 and 3 have Similar Configurations.

DOVER ALTERNATIVE 2

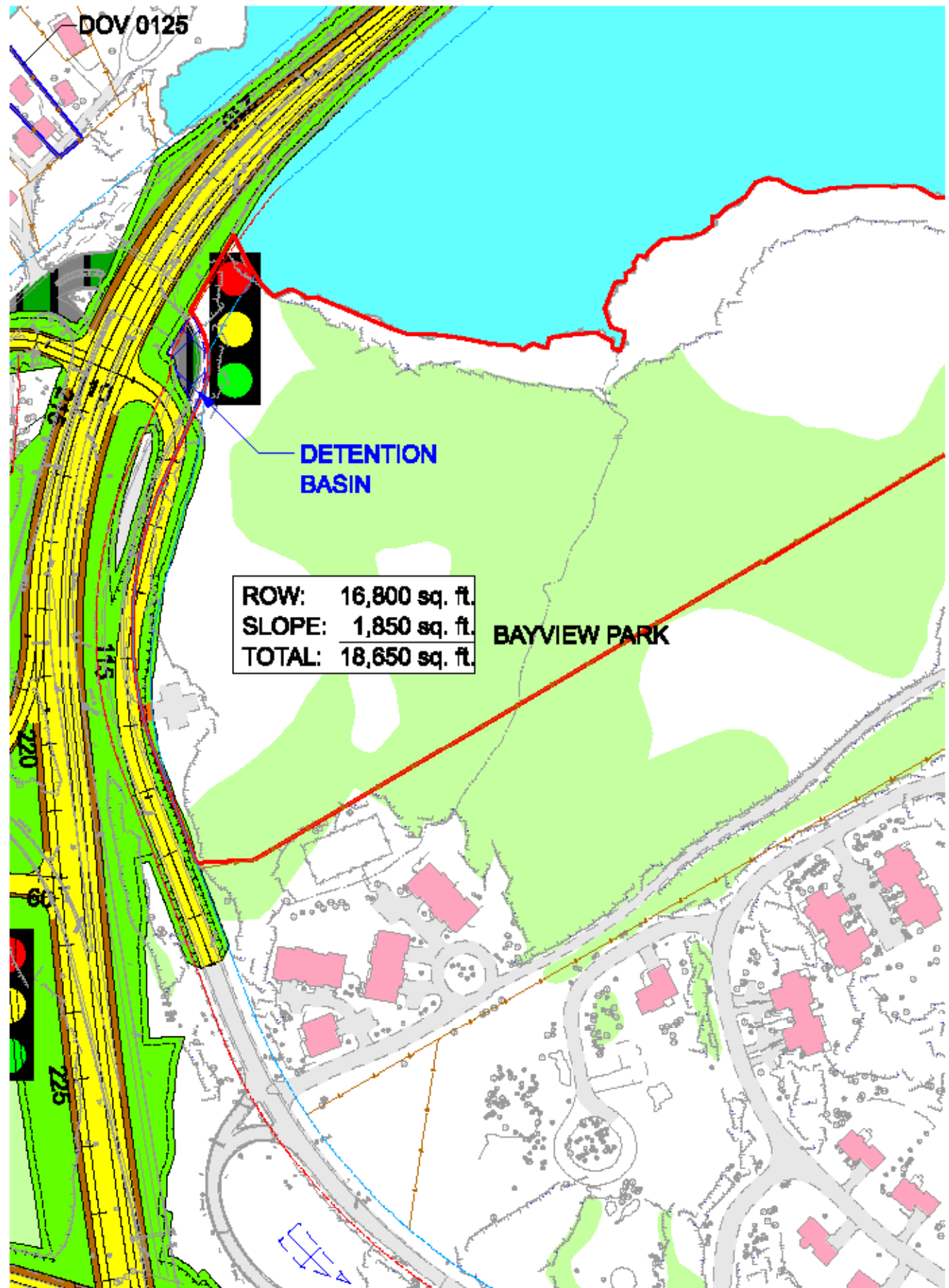

DOVER ALTERNATIVE 3

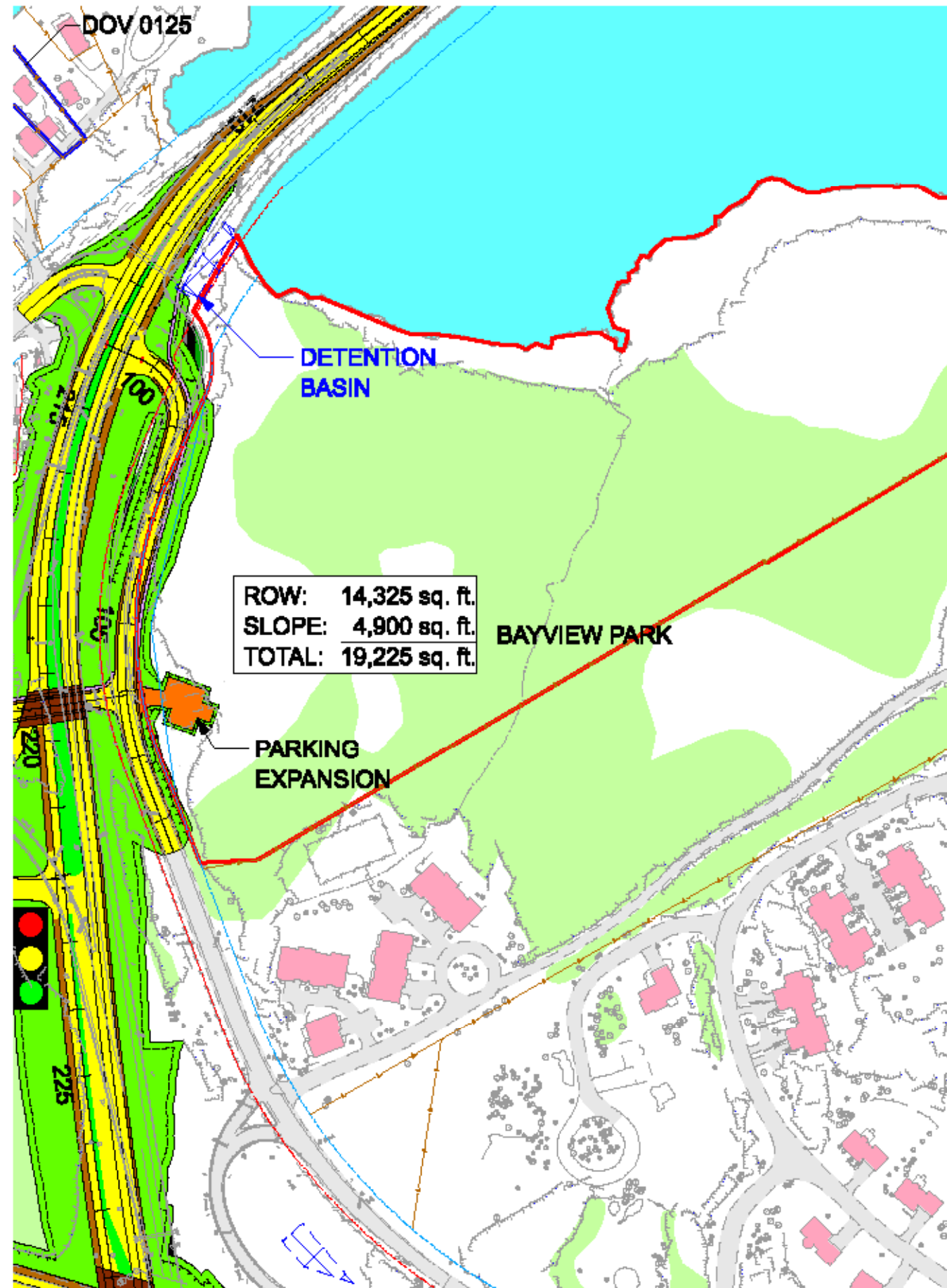

Legend:

- Existing Roadway
- Existing Building
- Existing Wetland
- Existing Property Lines
- Proposed Roadway
- Proposed Bridge
- Proposed Rail Corridor
- Proposed Acquisition
- Pavement Removal
- Existing LAROW
- Existing CAROW
- Existing ROW
- Proposed LAROW
- Proposed CAROW
- Proposed ROW
- Historic Structure (Listed or Eligible for Listing)
- Park Boundary

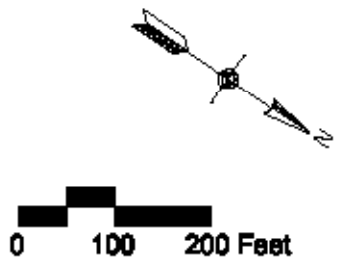

Vansse Hangen Brustlin, Inc.

Figure 5.4-5  
Section 4(f) Impacts  
Bayview Park  
Dover

