

**NH Division of Historical Resources
Determination of Eligibility (DOE)**

Date received: 2/2/05, 11/16/05 Inventory #: DOV0093
Date of group review: 2/9/05, 12/14/05 Area: Newington-Dover Project Area (ND)
DHR staff: Linda Wilson Town/City: Dover
Property name: Ira F. Pinkham House County: Strafford
Address: 430 Dover Point Road

Reviewed for: ☒ R&C ☐ PTI ☐ NR ☐ SR ☐ Survey ☐ Other
Newington-Dover, NHS-027-1(37), 11238

Individual Properties

NR	SR
<input checked="" type="checkbox"/>	<input checked="" type="checkbox"/> Eligible
<input type="checkbox"/>	<input type="checkbox"/> Eligible, also in district
<input type="checkbox"/>	<input type="checkbox"/> Eligible, in district
<input type="checkbox"/>	<input type="checkbox"/> Not eligible
<input checked="" type="checkbox"/>	<input type="checkbox"/> More information needed
<input type="checkbox"/>	<input type="checkbox"/> Not evaluated for individual eligibility

Districts

NR	SR
<input type="checkbox"/>	<input type="checkbox"/> Eligible
<input type="checkbox"/>	<input type="checkbox"/> Not eligible
<input type="checkbox"/>	<input type="checkbox"/> More information needed
<input type="checkbox"/>	<input type="checkbox"/> Not evaluated @ district

Integrity: ☒ Location ☒ Design ☒ Setting ☒ Materials
 ☒ Workmanship ☒ Feeling ☒ Association

Criteria: ☒ A. Event ☐ B. Person ☒ C. Architecture/Engineering
 ☐ D. Archaeology ☐ E. Exception

Level: ☒ Local ☐ State ☐ National

STATEMENT OF SIGNIFICANCE:

☐ IF THIS PROPERTY IS REVIEWED IN THE FUTURE, ADDITIONAL DOCUMENTATION WILL BE NEEDED.

The Ira F. Pinkham House is eligible for the National Register for its historical associations with several important historical contexts on Dover Point – brickmaking, agriculture and summer home tourism – as well as its architectural significance as a mid-19th century farm complex altered to serve the needs of early 20th century summer residents.

To finalize this determination of eligibility, a boundary justification and map are needed for the eligible property.

12/14/05 - Boundary information received and approved.

☒ ENTERED INTO DATABASE

ACREAGE: 0.80 acres

PERIOD OF SIGNIFICANCE: c.1853 – 1955

AREA OF SIGNIFICANCE: industry, agriculture, architecture, community planning and development

BOUNDARY: to be determined see page A1

SURVEYOR: Preservation Company

FOLLOW-UP: Notify agencies and surveyor, of the need for more information.

Final DOE approved by:

EZE Muzzey (ME)

INDIVIDUAL INVENTORY FORM

NHDHR INVENTORY NUMBER: DOV0093

Name, Location, Ownership

1. Historic name: Ira F. Pinkham House
2. District or area: N/A
3. Street and number: 430 Dover Point Road
4. City or town: Dover
5. County: Strafford
6. Current owner: Fast Dogs Realty LLC,
Dover State of NH

Function or Use

7. Current use(s): domestic
8. Historic use(s): domestic, agriculture

Architectural Information

9. Style: 1½-story sidehall
10. Architect/builder: Unknown
11. Source: N/A
12. Construction date: ca. 1853
13. Source: Research, Inspection
14. Alterations, with dates: ell and addition
(late 19th century), asbestos shingles
(ca. 1930), enclosed porch (ca. 1940)
15. Moved? no ☒ yes ☐ date: N/A

Exterior Features

16. Foundation: brick
17. Cladding: asbestos shingles
18. Roof material: asphalt shingles
19. Chimney material: brick
20. Type of roof: gable, front
21. Chimney location: (2ea.) ridge, center;
ell ridge, center
22. Number of stories: 1½
23. Entry location: southeast corner
24. Windows: 1/1, casement
Replacement? no ☐ yes ☒ date:
early 20th c.

Site Features

25. Setting: residential, abutting highway
26. Outbuildings: barn (1886), shed (1940)
27. Landscape features: highway, paved
driveway



35. Photo 1
36. Date May 2003
37. Roll: 2003-13 Frame: 7 Direction: N
38. Negative stored at: NHDHR

28. Acreage: 0.80 acres
29. Tax map/parcel: 8/8-29
30. UTM reference: 19.350010.4775810
31. USGS quadrangle and scale: Portsmouth, NH-ME, 1:24000

Form prepared by

32. Name: Beth Hostutler (11/91); Preservation Company
(11/04)
33. Organization: Preservation Company
34. Date of survey: 11/91 and 11/04

NH SP NAD 83' E1207275 N227921

FEB 02 2005

INDIVIDUAL INVENTORY FORM

NHDHR INVENTORY NUMBER: DOV0093

39. LOCATION MAP:

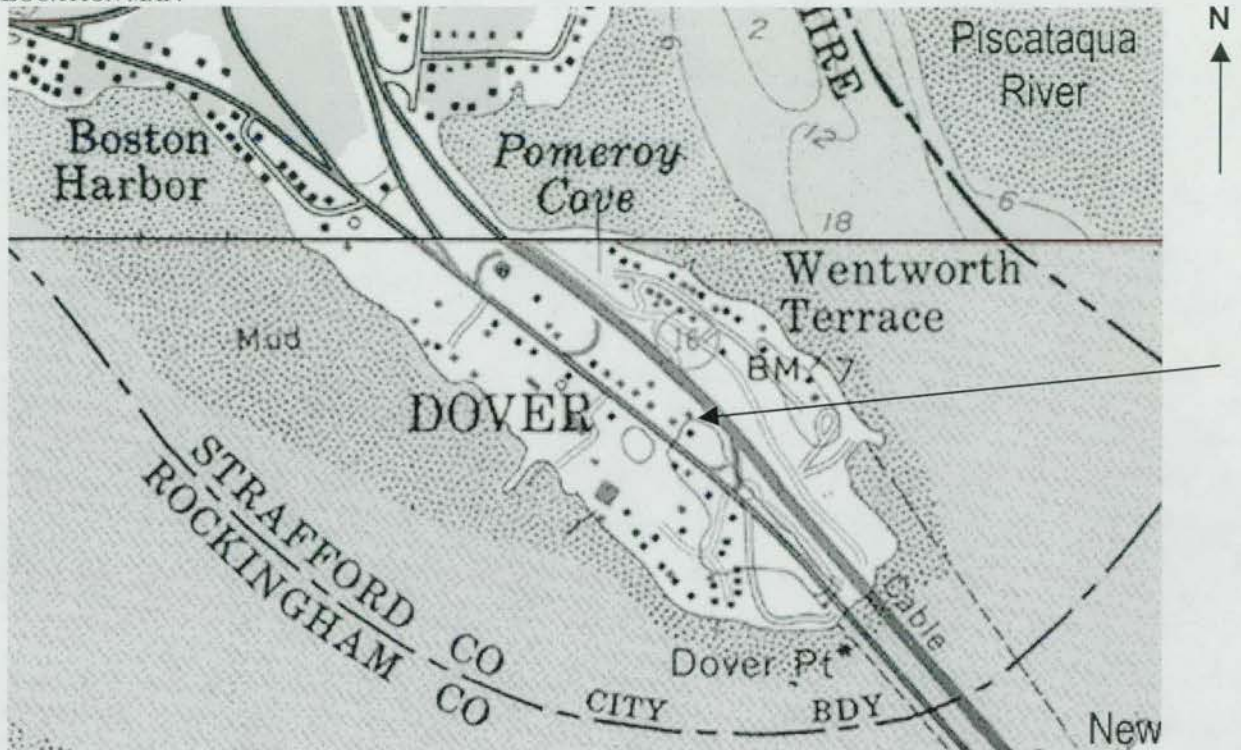

40. PROPERTY MAP:

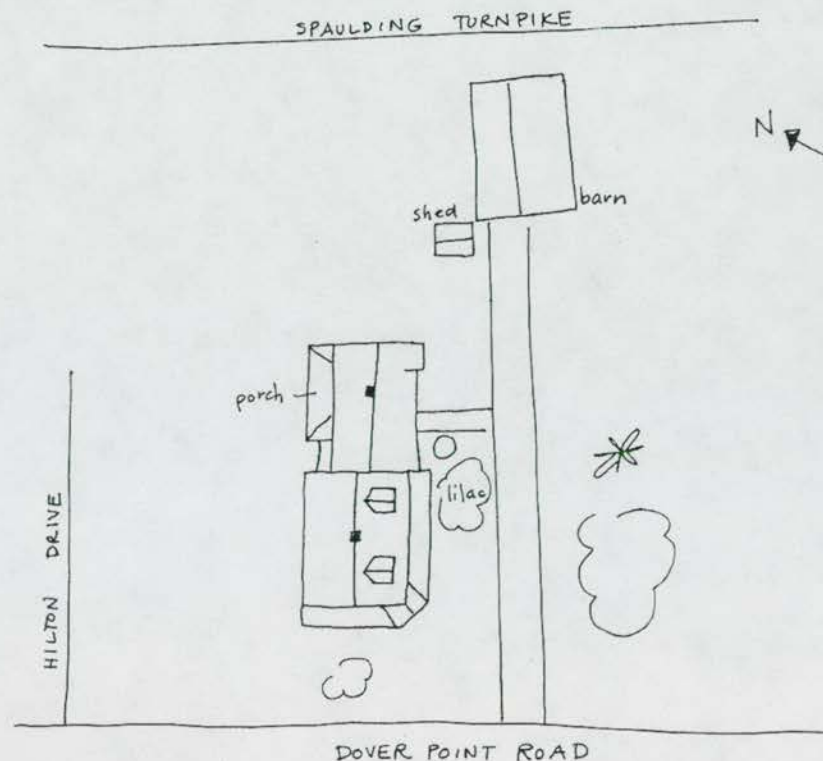

INDIVIDUAL INVENTORY FORM

NHDHR INVENTORY NUMBER: DOV0093

41. Historical Background and Role in the Town or City's Development:

In 1853, Ira F. Pinkham (1833-1907) bought a half-acre lot from Thomas and William Card located just north of the John P. Hanson property (Deed 1853; Sinnett 1908:36). By 1856, Pinkham had constructed the existing Ira F. Pinkham House on this lot. Pinkham increased his land holdings to approximately eight acres with the purchase of two additional parcels from the Cards in 1859 and again in 1871 (Chace 1856; Deed 1859; Deed 1871).

The son of Enoch Pinkham, an established Dover Point brickmaker on Dover Point who had operated a yard at the southernmost tip since about 1830, Ira Pinkham initially made a living as a freighter on the river with Clark Matthews of Newington (Scales 1923:59). However, by 1860 he had joined in the family tradition and was listed as a brickmaker in the census, operating a brickyard just south of Pomeroy Cove (Sinnett 1908:36). Ira Pinkham purchased a two-acre brickyard from his father in 1873, but sold it, along with stock, water, and railroad privileges, to James Coleman of Eliot, in 1888 (Deed 1888; Adams 1976:110).

As was common on Dover Point, Ira Pinkham farmed in addition to manufacturing bricks. The 1870 agricultural census shows him with seven acres of improved land upon which he was harvesting potatoes (three bushels), orchard products (three bushels), hay (three tons), an average sized farm for the thirteen farmers on Dover Point at the time. A single horse, cow and swine made up his livestock holdings. The 1880 census lists him as a farmer. Throughout the nineteenth century, most brickmakers on the Point combined the occupations of brick manufacturing and farming.

Married in 1862, Pinkham and his wife Syrena (Cousens), who was originally from Kennebunk, Maine, raised two daughters in the Ira F. Pinkham House -- Sena Pinkham Saunders and Ella Pinkham Spinney (Sinnett 1908:36-37). Syrena died in January 1907, and Ira passed away less than a month later (Probate x528). The Pinkham daughters inherited the property and subsequently sold it to William W. and Edith A. Finley in 1910 (Deed 1910). The Finleys, who resided in downtown Dover, either rented the property or used it as a summer residence until they sold to Frank and Annie E. Wentworth in 1912.

Beginning in the 1920s, Wentworth acquired significant acreage on Dover Point, which he subdivided and sold as both empty and built-on lots in the 1930s and 1940s (Bartlett 1992). His holdings included the Ira F. Pinkham House, properties DOV0103, DOV0101, DOV0100, DOV0102, DOV0095 and DOV0094, and the Wentworth Terrace properties (DOV0088, DOV0086, DOV0087, DOV0089) (Bartlett 1992). An entrepreneur, Wentworth founded a business selling bicycles in Dover at the turn of the century, later expanding into auto sales and opening a car dealership (Whitehouse 1992).

The Wentworth's used the Ira F. Pinkham House as both a summer and year-round residence until 1955 (Bartlett 1992, Deed 1912). The Wentworths likely added the porch and applied the asbestos shingle wall cladding. In addition, the Wentworths sold much of the original Pinkham holdings, developing properties DOV0097, DOV0095, DOV0094 and Wentworth Terrace on it.

A number of people have owned the Ira F. Pinkham House since the Wentworths. The United Brotherhood of Carpenters and Joiners of America bought the property in 1986 to use as their union hall (Deed 1986), but that use has never been activated.

42. Applicable NHDHR Historic Contexts:

36. Brickmaking for local and regional markets, 1650-1920.

INDIVIDUAL INVENTORY FORM**NHDHR INVENTORY NUMBER: DOV0093**

48. Mixed agriculture and the family farm, 1630-present.

70. Summer home tourism, 1880-present.

43. Architectural Description and Comparative Evaluation:

The Ira F. Pinkham House, built ca.1853, is one of three 1½-story sidehall plan houses in close vicinity on Dover Point Road, but they have all been altered somewhat because of the addition of asbestos siding and enclosed wraparound porch (DOV0098 and DOV0096). The house is oriented gable-end to the street and is supported by a brick foundation. The walls were sheathed with asbestos shingles ca. 1950. The gable roof is sheathed with asphalt shingles; the eaves project and return with molded fascia boards. Brick stove chimneys are centered on the ridges of the main block and ell. Two gable dormers are evenly spaced on the southeast roof slope. The original fenestration pattern remains behind the enclosed porch and on other elevations, with 1/1, double-hung sash, topped with molded lintels and plain surrounds. An early twentieth century, one-story, enclosed porch wraps around the façade and southeast elevation. The porch is sheathed with wood shingles and lit by horizontal sliding windows. The main entry to the porch is on the angled northwest corner.

A 2-story, 3-bay deep ell with a shallow gable roof projects from the northeast elevation. The ell is trimmed in a manner similar to the house. One-story additions to the ell have been added on the northwest and southeast elevations.

A large barn, ca. 1886, oriented gable end to the street, is located northeast of the house. The barn is sheathed with clapboards, covered with asbestos siding, and retains its original fenestration. The eaves project and return on the gable ends. A vertical board, internal, sliding door is centered on the façade, topped with boards that may cover a transom light, 6/6, double-hung sash windows and a round-headed window in the gable. The drive-through capacity was served by a large overhead door on the rear elevation. There are fixed windows on southeast elevation. A paved driveway, lined with shrubbery, connects the barn and Dover Point Road. A ca.1940 shed, sheathed with wood clapboards, stands at the west corner of the barn.

The Ira F. Pinkham House is located on a cleared 0.80-acre lot between Dover Point Road and the Spaulding Turnpike. Split rail and chain link fences surround the property.

44. National or State Register Criteria Statement of Significance:

The Ira F. Pinkham House is eligible for the National Register of Historic Places.

Criterion A: The Ira F. Pinkham House is of eligible for the National Register for its associations with two significant nineteenth and twentieth century trends on Dover Point. The Pinkahm House has strong associations with the brick making industry on Dover Point and the common practice of combining agriculture as a means of making a living. The house and barn have sufficient integrity to convey these associations. Ironically, the size of the lot is nearly the same as when the house was constructed. Additionally, the Pinkham House, as the summer home of local developer Frank Wentworth, has strong associations with the early twentieth-century development of Dover Point as a seasonal destination, and working class housing. The alterations made during the Wentworth period convey its associations with that period in Dover Point's history.

INDIVIDUAL INVENTORY FORM**NHDHR INVENTORY NUMBER: DOV0093**

Criterion B: The Ira F. Pinkham House has strong associations with the prominent local brick manufacturer, and prominent local builder Frank Wentworth. It is of strong local significance for these associations and maintains sufficient integrity to document them.

Criterion C: The original sidehall plan and mid-nineteenth century architectural details of the Ira F. Pinkham House are obscured by the early twentieth century additions that have themselves been altered with non-historic applications. However, the set of buildings is significant for documenting the taste of prominent businessmen and methods of construction employed by local builders in the mid-nineteenth century, and the same for owners in the twentieth century.

45. Periods of Significance:

ca.1853 – ca. 1907 Ira Pinkham

1912-1955 Frank Wentworth

46. Statement of Integrity:

The Ira F. Pinkham House retains sufficient integrity to convey its historic associations. It retains integrity of location and setting on the same size lot on which it was constructed. The enclosure of the wrap-around porch, application of asbestos shingle wall cladding were done during the period of significance. The replacement of some of the original window sash affects the integrity of feeling, design and materials somewhat, but the workmanship and association are still intact. If non-historic alterations were removed in the future, the Ira F. Pinkham House would have far greater integrity.

47. Boundary Discussion:

The boundary for the eligible property is the parcel currently associated with ownership in the tax assessor's records of the city of Dover, parcel 8-29 on map 8.

48. Bibliography and/or References:

Adams, John P.

1976 Drowned Valley: The Piscataqua River Basin. Hanover, NH: University Press of New England.

Anonymous

1912-13 Dover City Directories. Collection of the Dover Public Library, Dover, NH.

Sinnett, Rev. C.N.

1908 Pinkham Genealogy. Concord, NH: Rumford Printing Co.

Scales, John D.

1923 History of Dover, NH. Manchester, NH: John B. Clarke Co.

Deeds – Strafford County Courthouse

1986 Book 1272, page 798

INDIVIDUAL INVENTORY FORM

NHDHR INVENTORY NUMBER: DOV0093

1986 Book 1226, page 513
1974 Book 943, page 443
1970 Book 874, page 444
1955 Book 650, page 93
1949 Book 567, page 216
1944 Book 521, page 83
1943 Book 515, page 13
1934 Book 458, page 394
1930 Book 442, page 491
1912 Book 336, page 24
1910 Book 359, page 84
1908 Book 350, page 254
1908 Book 349, page 374
1873 Book 252, page 553
1871 Book 250, page 528
1859 Book 227, page 326
1853 Book 213, page 363

Interviews

Mary Bartlett, longtime resident, February 10, 1992.

Maps

Chace, J. Jr.

1856 "The Town of Dover, Strafford County, New Hampshire." Philadelphia: Smith and Bartlett.
Collection of the New Hampshire Historical Society, Concord, NH.

Hurd, D.H. & Co.

1892 Town and City Atlas of the State of New Hampshire. Boston: D.H. Hurd & Co.

Sanford & Everts

1871 Atlas of Strafford County, New Hampshire. Philadelphia: Sanford & Everts. Collection of
the New Hampshire Historical Society, Concord, NH.

Surveyor's Evaluation

NR listed: individual ☐
within district ☐

Integrity: yes ☒
no ☐

NR eligible:
individual ☒
within district ☐
not eligible ☐
more info needed ☐

NR Criteria: A ☒
B ☒
C ☒
D ☐
E ☐

INDIVIDUAL INVENTORY FORM

NHDHR INVENTORY NUMBER: DOV0093

Address: 430 Dover Point Road Date taken: May 2003 Negative stored at: NHDHR



Photo 2: side (southeast) elevation; rear ell

Roll: 2003:13 Frame: 9 Direction: W



Photo 3: rear (southwest) and side (northwest) elevations

Roll: 2003:13 Frame: 11 Direction: S

INDIVIDUAL INVENTORY FORM

NHDHR INVENTORY NUMBER: DOV0093

Address: 430 Dover Point Road Date taken: May 2003 Negative stored at: NHDHR



Photo 4: barn, façade and side (southeast) elevation; shed (at left)

Roll: 2003:13 Frame: 8 Direction: N



Photo 5: barn, rear (northeast) and side (northwest) elevations; shed (at right)

Roll: 2003:13 Frame: 10 Direction: S

INDIVIDUAL INVENTORY FORM

NHDHR INVENTORY NUMBER: DOV0093

Address: 430 Dover Point Road Date taken: November 1991 Negative stored at: NHDHR



Photo 6: façade and side (southeast) elevation
Roll: 1991-4 Frame: 7 Direction: NE



Photo 7: façade and side (northwest) elevation
Roll: 1991-4 Frame: 5 Direction: SE

INDIVIDUAL INVENTORY FORM

NHDHR INVENTORY NUMBER: DOV0093

Address: 430 Dover Point Road Date taken: November 1991 Negative stored at: NHDHR



Photo 8: barn (left), shed (center), house (right; rear and side elevations)

Roll: 1991-4 Frame: 4 Direction: S



Photo 9: barn, façade

Roll: 1991-4 Frame: 6 Direction: NE

INDIVIDUAL INVENTORY FORM

NHDHR INVENTORY NUMBER: DOV0093

Addenda – Completed November 2005 by Preservation Company

430 Dover Point Road – Ira F. Pinkham House

47. Boundary Discussion:

The Ira F. Pinkham House is located east of Dover Point Road on the corner of Wiggin Drive (also known as Hilton Drive). The parcel on which the buildings are located presently contains 0.8 acres. The boundary of the National Register eligible property is defined by the legally recorded lot lines of this parcel as shown on tax map 8, parcel 8-29 in the Dover tax records. The boundary is a trapezoidal shape that includes the house and its ell as well as the outbuildings.

The Ira F. Pinkham House was originally associated with the large Pinkham family farm and brickmaking business. Later businessman Frank Wentworth occupied it as a summer home. The parcel is all that remains of the large amount of land amassed by Ira Pinkham and later by Frank Wentworth. The property was deemed significant under Criteria A and C. Unfortunately, the surrounding area has lost integrity due to the construction of the Spaulding Turnpike, the infill of numerous small homes and commercial establishments so this parcel is all that remains to document the early use.

